



*Portnall Road, London, W9 3BB
Offers In The Region Of £600,000 Share of*





2 x  1 x  1 x 

A two bedroom ground floor garden flat measuring 613 sq ft situated in a Victorian terrace on Portnal road just newly renovated. Both bedrooms are doubles the first measuring 13'11" x 12'6" and the second very similar in size. The reception and galley kitchen are bright and airy benefitting from windows to the back and to the side return. Also with a contemporary bathroom and window to the back. Benefits include a possibility to extend out into the side return which already has planning permission in place. Close to the Queens Park tube and the shops and bars of Salisbury road. Share of Freehold.



Portnall Road, London, W9

Approximate Gross Internal Area

633 sq ft - 57 sq m

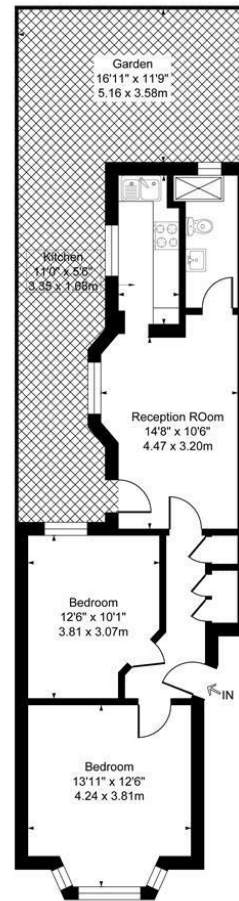

Ground Floor

Illustration for identification purposes only, not in scale

Important Notice Debussy Property Service Ltd trading as Braithwait for themselves and for the vendor of this property whose agents they are, give notice that (i) these particulars do not constitute any part of an offer or contract, (ii) all statements contained within these particulars are made without responsibility on the part of Braithwait or the vendor, (iii) whilst none in good faith, none of the statements contained within these particulars are to be relied upon as a statement of representation or fact, (iv) any intending purchaser must satisfy him/herself by inspection or otherwise as to the correctness of each of the statements contained within these particulars, (v) the vendor does not make or give either Braithwait or any person within their employment any authority to make or give any representation or warranty whatsoever in relation to this property. Wide angled lenses may be used in photographs.

Call us on 0207 289 8889 or email sales@braithwait.co.uk

